

SPECIFICATIONS

- ◆ external resolution.....max 1/4,000
- ◆ operating temperature.....0°C ~ +40°C
- ◆ operating humidity.....0 ~ 80%
- ◆ safe overload.....120%F.S
- ◆ max overload.....150%F.S
- ◆ max capacity 2000kg

STANDARD FEATURES

- ◆ 4 load cell
- ◆ Waterproof junction box
- ◆ Rechargeable battery 6V/10Ah
- ◆ Backlit 52mm LCD display



OPTIONS

- ◆ Built-in mini printer

FEATURES

- ◆ Four load cell accuracy
- ◆ Rugged and dependable
- ◆ Overload up to 150%
- ◆ Waterproof junction box
- ◆ User defined (free set) print format
- ◆ Built-in rechargeable battery, up to 60 hours operation
- ◆ Function include change weighing unit, net/gross shift, pretare, Accumulate

DIMENSIONS (mm)

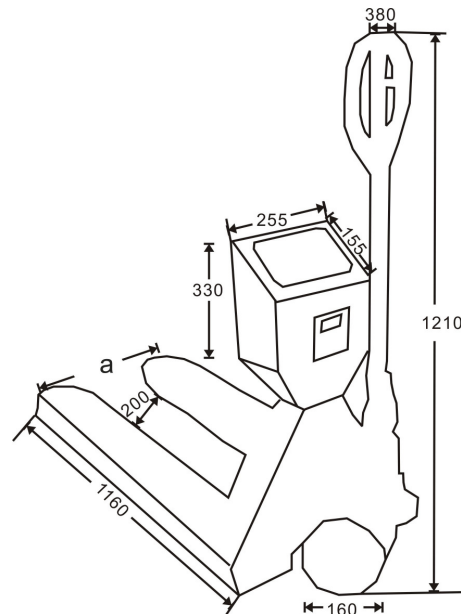

Fork Overall Width (a)	555 MM
Fork height lowered	85mm
Fork height raised	200mm

Models and specification are subject to change without notice

Supplied by,

Wessex Scale Co, Lower Mill, Exford Nr Minehead Somerset TA24 7QE

Tel: 0845 472 5345 Fax: 01643 800 299

Email: sales@wessexscales.co.uk

Website: www.wessexscales.co.uk